



The Corporation of the Village of Salmo

REPORT TO COUNCIL

DATE: May 7, 2021
RE: Lions Park Proposed Playground
SUBMITTED BY: Anne Williams, Chief Administrative Officer

BACKGROUND:

In 2019 the Village applied to and received a grant in the amount of \$32,397 (75% of costs total project estimate of \$43,196) from the CBT's *Community Outdoor Revitalization Grants* program for a new public washroom, drinking fountain and landscaping (flowers & shrubs) at Lions Park.

Work did not commence in either 2019 or 2020 due a delayed decision on where to locate the washroom. It is now to be located in the large equipment storage building when it is refurbished. Therefore, the CBT was asked: *Could the money could be used to build a playground in the park or did the money need to be returned to them?* They have agreed a playground would be an acceptable project under this grant program and granted an extension to July 31, 2021 to complete the work. As originally planned, some landscaping at the front of the park would also take place.

The Salmo Valley Lions Club has advised they would potentially purchase an accessible dish swing like the one in KP Park for this project, which will further enhance the play space. There is also the potential for reaching out to local groups for volunteer assemblers as they may wish to be involved.

PURPOSE OF THIS REPORT:

To provide Council with information in order to make a decision on:

1. The location of the playground.
2. What type of playground you think villagers would like to see in the park.

To provide estimated cost of playground space, equipment and landscaping.

LOCATION CHOICES:

There are three proposed choices for the location of the playground none of which impede access to the Glendale Well. Spaces are shown as the maximum space available in that location, they can be made smaller. They are attached as:

Note: Drawings are not to scale.

OPTION 1 (staff's recommended choice) – a 90' long x 55' wide rectangular space located between the back of the curling rink and the ball diamond nestled up close to Cottonwood Avenue and running over to mid-way through the location of the team dugout.

Option 1 Pros:

- Close to ball diamonds and bleachers so parents can watch their children while their other children or themselves either play or watch ball.
- Out of the way for snow plowing and snow dumping leaving plenty of space for those activities.
- Cottonwood Avenue access is already closed off.
- Easy access for neighbourhood children via Cottonwood Avenue and they don't have to come in via the main park entrance/parking lot making it safer for them.
- Would enhance the park visually and physically for users.

Option 1 Cons:

- Could be hit by a foul ball, but the back-stop is nice and high there reducing likelihood.

OPTION 2 – a 60' x 60' square located at the back of the parking lot, behind the well, adjacent to the skating rink.

Option 2 Pros:

- Can be easily accessed from Cottonwood Avenue or the parking lot and the ball field area.
- Would enhance the park visually and physically for users.

Option 2 Cons:

- Likely inhibits snow plowing and removal.
- Impedes access to batting cage and possibly the skating rink.
- Not as close to bleachers making it more difficult for parents to keep an eye on children while watching or playing ball themselves.
- Possible damage from kids wearing skates due to its proximity to the rink.

OPTION 3 (staff's second choice) – a 60' long x 50' wide rectangle located at the back of the parking lot between the parking lot and the ball field dugout, starting roughly at the corner of the curling rink.

Option 3 Pros:

- Highly visible location. Would enhance the park visually and physically for users.
- Less impact on snow removal than Option 2.

Option 3 Cons:

- May inhibit snow plowing and removal.
- Could possibly impede access to batting cage.
- Not as close to far bleachers making it more difficult for parents to keep an eye on children while watching or playing ball themselves.
- Possible damage from kids wearing skates due to its proximity to the rink.

PLAYGROUND EQUIPMENT

Staff sought quotes from three Canadian suppliers. Two responded and provided the attached quotes. The final choices are not set as equipment can be easily switched out for another option. Both suppliers provided the quotes based on sales they are currently having, so the village would get more "bang-for-our-buck" going with all or most of their recommended choices. Either playground will be accessible to children with disabilities.

Delivery for both is 2-4 months from date of order so we would be looking at installation in August or September. However, site prep needs to take place first anyway so Civic Works can get that done over the summer. Another deadline extension from the CBT would need to be asked for, but I don't anticipate that being a problem as long as the equipment is on order.

Quote # 1 – Henderson – North Saanich

Canadian manufacturer Green Roots Play Equipment-
<https://www.greenrootsplayequipment.ca/index.php>

Disk swing comes from Germany and is not suitable for a baby.

Exclusive of GST (no PST) and including installation \$28,776

This consists of a PlaySteel FIT structure (see attached), a Lucky Clover, a Skateboard Rider, a swirly spinner and a picnic table (which can be changed to something else), and freight to Nelson of \$2,400. A free "Buddy Bench" is also included for orders over \$12K. They can also supply the disc swing but have not quoted it.

The installation cost of \$6,414 is for them to do the whole assembly. If they do the installation PST is not charged. Civic Works would do the ground prep as advised by them.

Quote #2 – SwingTime/Blue Imp – North Vancouver

Canadian manufacturer Blue Imp - <https://swingtimedistributors.com/> (we have a Blue Imp in KP Park) All equipment comes from Canada.

Exclusive of taxes (GST) \$29,961.07, PST is included

With installation supervision - \$33,911.07

This quote consists of a Blue Imp Prairie Gold Play Structure, a Quark climber, a School Bus with coil spring, shipping \$1,500. Supervised installation would be \$3,950 extra and the Village would have to supply the installation crew. They can also quote and supply a disc swing.

Disk swing is suitable for a baby.

STAFF EQUIPMENT RECOMMENDATION

Either supplier would provide a quality playground, however, while Henderson offers more for our money and complete installation, .

SITE PREP ESTIMATE

Labour, Equipment & Materials – Estimated cost \$10,799.

- Grading site
- Hole digging & concrete pouring
- Pea gravel – 12" deep
- Pea gravel spreading
- Planters – 2 (self-watering, purchased in 2019 \$1,000)

- Flowers and shrubs for planters

If Swing Time is selected there would be an additional two days labour for two Civic Works persons, estimated at \$700-\$800.

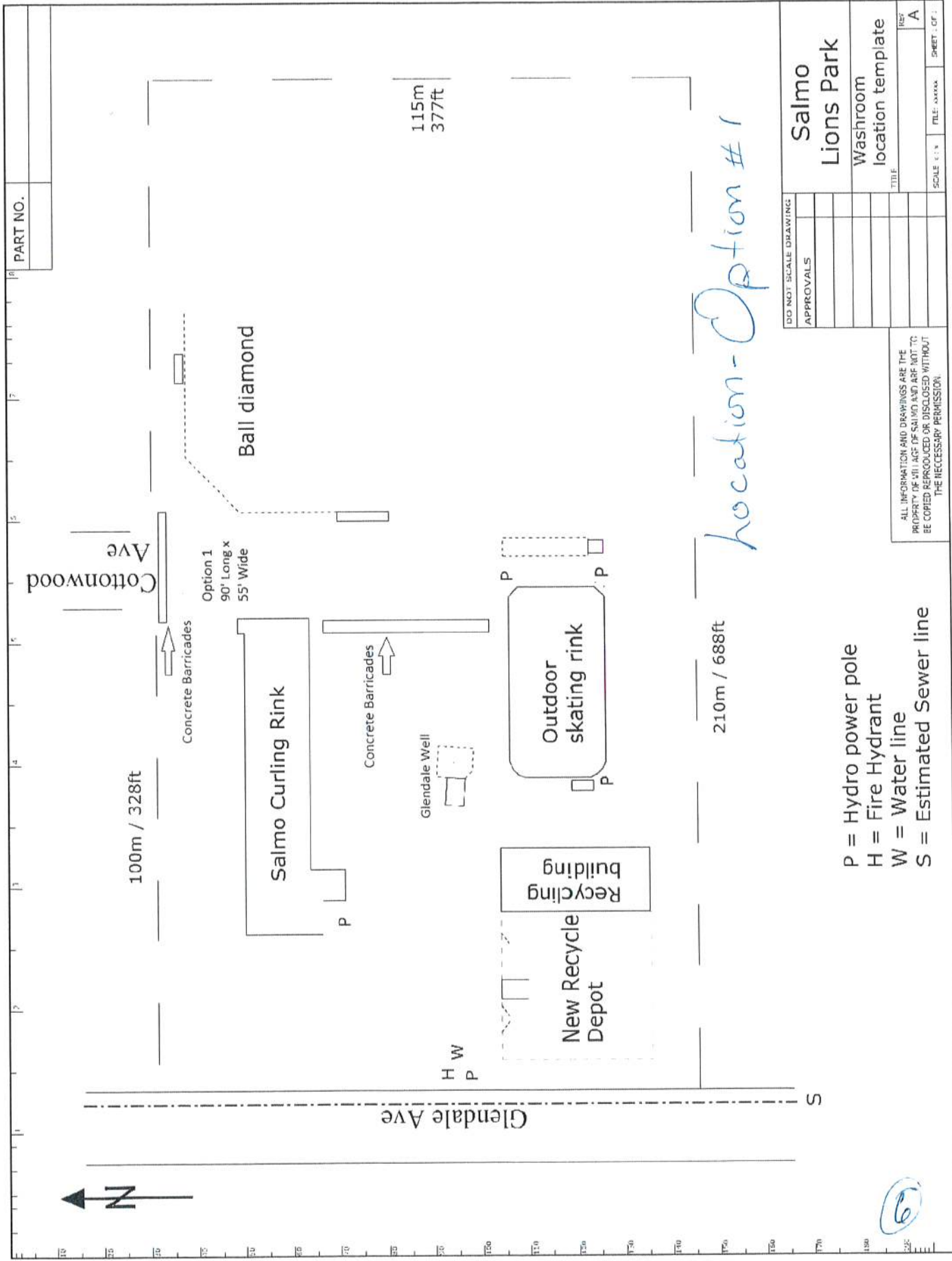

PART NO.

location - Option #1

DO NOT SCALE DRAWING	
APPROVALS	
TITLE	REV
Salmo Lions Park	A
Washroom location template	
SCALE 1:1	FILE: ANXAK
	SHEET OF 1

ALL INFORMATION AND DRAWINGS ARE THE PROPERTY OF SALMO AND ARE NOT TO BE COPIED, REPRODUCED OR DISCLOSED WITHOUT THE NECESSARY PERMISSION.

- P = Hydro power pole
- H = Fire Hydrant
- W = Water line
- S = Estimated Sewer line

6

Location

OPTION #1
Battenwood Ave.

Ceiling
Print →



→
Ball
Fields



⑦



Option #1 - looking into park
from Cottonwood.

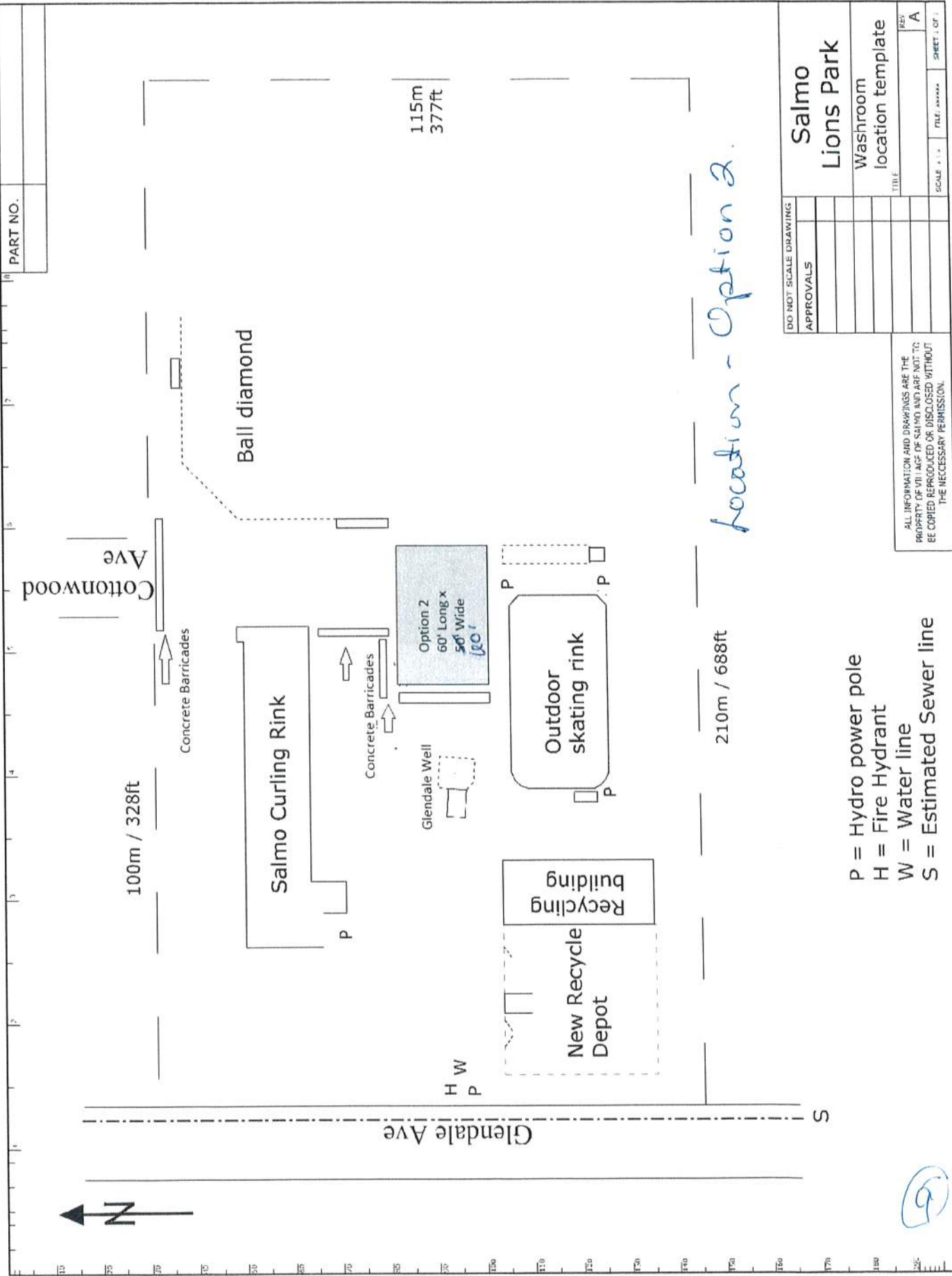

PART NO.

DO NOT SCALE DRAWING	Salmo Lions Park
APPROVALS	
	Washroom location template
	TITLE
	KEY
	A
	SCALE 1:1
	FILE: *****
	SHEET 1 OF 1

ALL INFORMATION AND DRAWINGS ARE THE PROPERTY OF THE CITY OF SALMO AND ARE NOT TO BE COPIED, REPRODUCED OR DISCLOSED WITHOUT THE NECESSARY PERMISSION.

- P = Hydro power pole
- H = Fire Hydrant
- W = Water line
- S = Estimated Sewer line



OPTION #2



Regard
Ball field
in back →

Ice rink ←

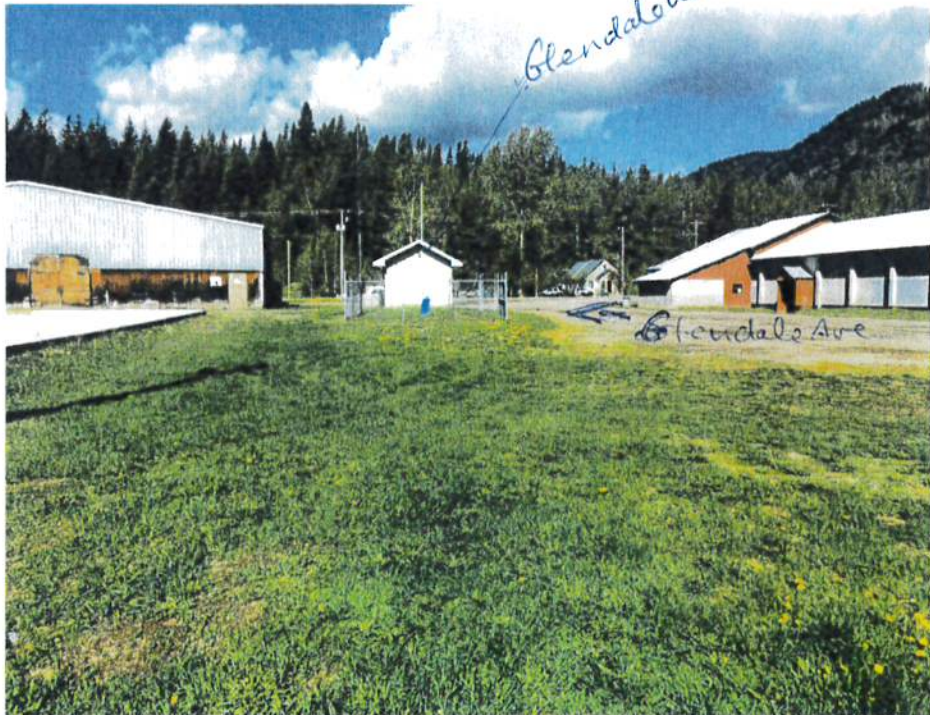

Recycle Bldg →

Ice rink →

Glendalwell

← Curling rink.

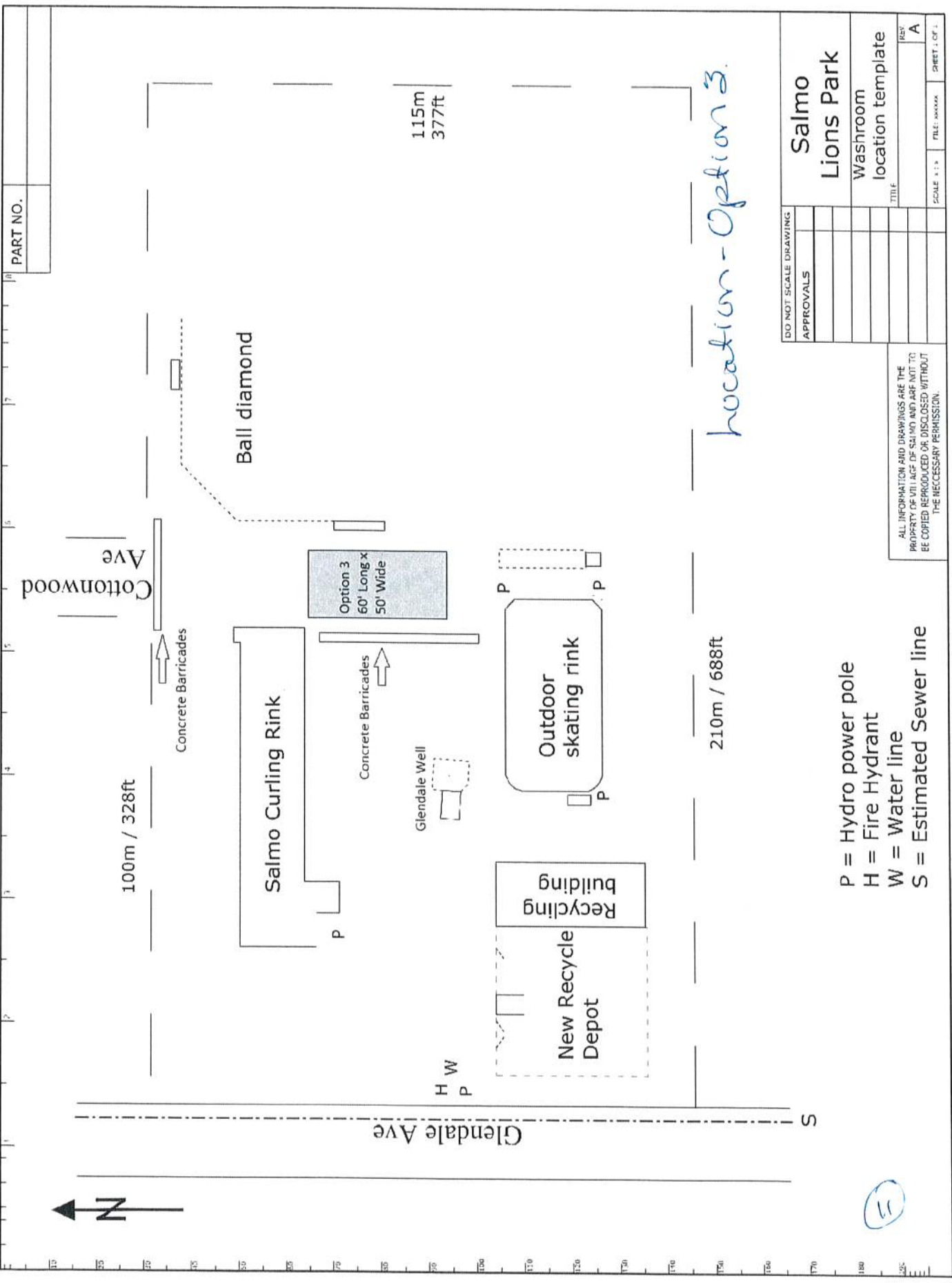

PART NO.

location - Option 3.

DO NOT SCALE DRAWING	
APPROVALS	
Salmo Lions Park	
Washroom location template	
TITLE	REV
	A
SCALE 1:10	SHEET 1 OF 1

ALL INFORMATION AND DRAWINGS ARE THE PROPERTY OF VILLAGE OF SALMO AND ARE NOT TO BE COPIED, REPRODUCED OR DISCLOSED WITHOUT THE NECESSARY PERMISSION.

- P = Hydro power pole
- H = Fire Hydrant
- W = Water line
- S = Estimated Sewer line

11

OPTION #3



Curling Rink →

↗ Cottonwood

← Diamond



Curling Rink →

← Cottonwood Ave.

← Ball Diamond

View from Park Entrance.



View from park to street.

13

Quote #1



About Green Roots

Green Roots Play Equipment Inc. is a locally owned and operated Canadian business.

Passionate about bringing communities together through play and providing children with fun, Green Roots provides challenging and dynamic equipment that brings outdoor play back to life.

Contact Us

Mo @ greenrootplayequipment
www.greenrootplayequipment.com
Local: 250-655-9973
Toll free: 1-855-887-2500
@greenplayteam



Henderson
Providing Playground Fun

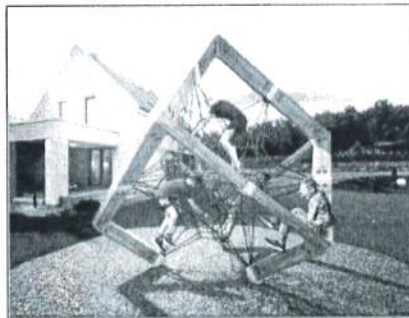

14



INNOVATION

Green Roots Play Equipment Inc is proud to be a supplier of Henderson Recreation, a 100% Canadian manufacturer. Purchasing Canadian products has many benefits, some of which include supporting Canadian made products, which supports our Canadian employment, labour and marketplace. Organizations that purchase Canadian made products also contribute environmentally by supporting product shipments within the country instead of supporting imported products, which reduced the environmental impact. Purchasing Canadian also avoids absorbing the high US exchange rate which is a large benefit economically.

Rigorous quality control measures are followed at the factory during the manufacturing process and are double checked prior to leaving the facility. This quality control then continues on with Green Roots Play Equipment prior to and during installation. The equipment is checked again upon unpackaging and is installed to the manufactures specifications to ensure that the CSA guidelines are met. If the purchasers are installing the playground, Green Roots is available anytime for any questions and support that may be needed.

Green Roots Play Equipment Inc is passionate about bringing communities together through play. We take great pride in our company values, our manufacturers and working with local communities and organizations to bring a smile to children's faces.





Henderson
Providing Playground Fun



Model No. B308096R0

VILLAGE OF SALMO
OPTION 1



50
YEAR
ANNIVERSARY



Henderson
Providing Playground Fun



Model No. B308096R0

VILLAGE OF SALMO
OPTION 1

Playground equipment distributed by:



17

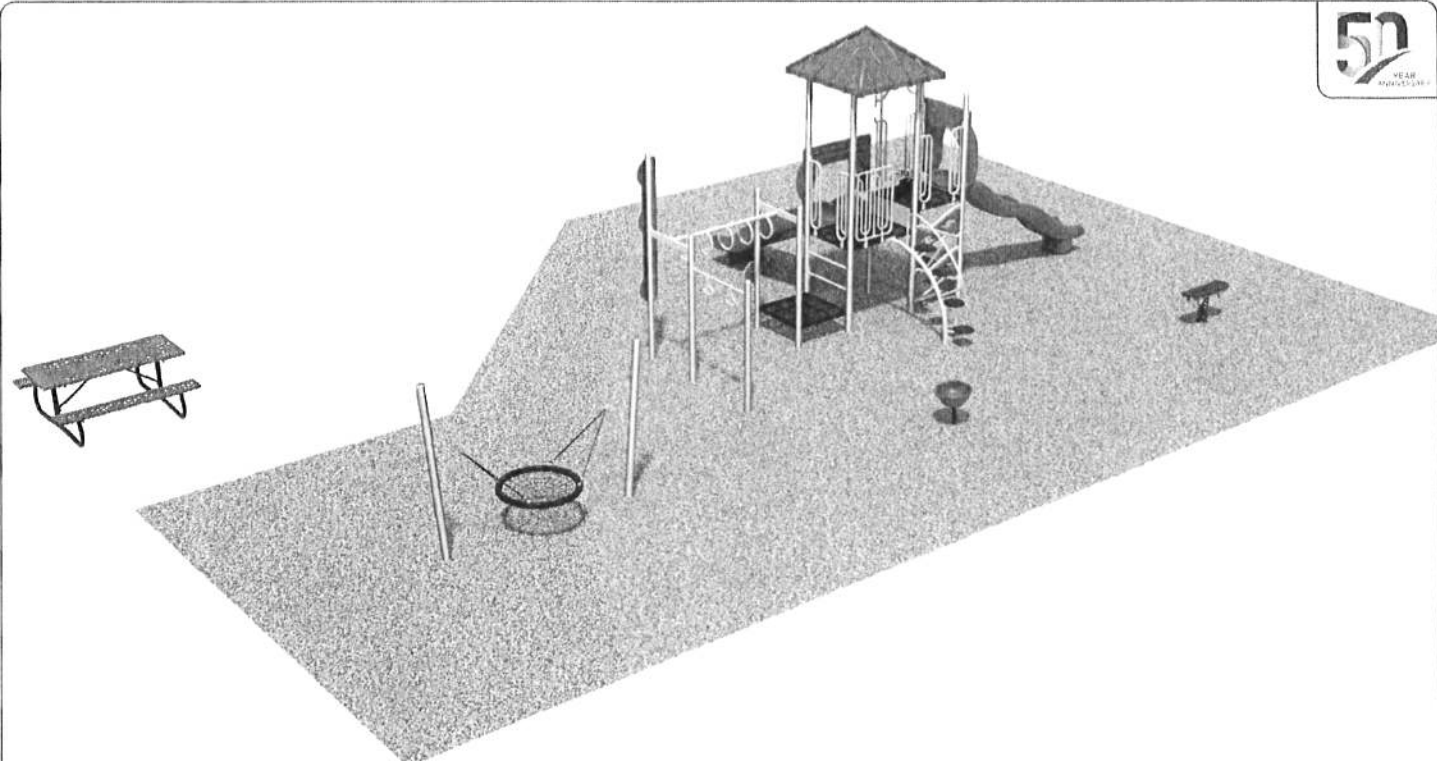

Henderson
 Providing Playground Fun



Model No. B308096R0

VILLAGE OF SALMO
 OPTION 1



18

Henderson
Providing Playground Fun

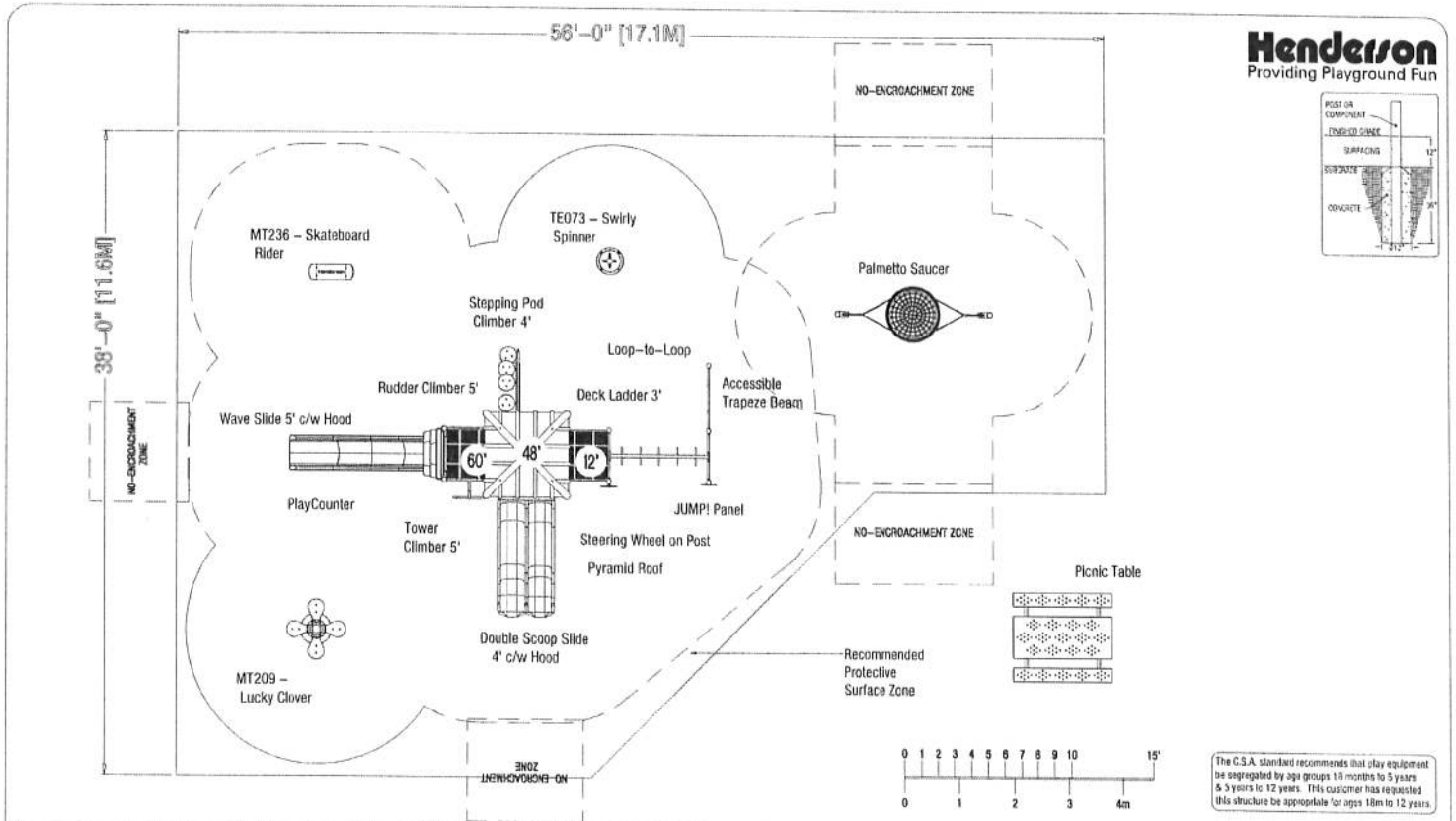
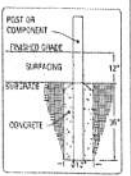

The C.S.A. standard recommends that play equipment be segregated by age groups 18 months to 5 years & 5 years to 12 years. This customer has requested this structure be appropriate for ages 18m to 12 years.

Model No. B308096R0
Green Roots Play Equipment, Inc.
Village of Salmo - Option 1

Henderson Recreation Equipment Ltd
PO Box 68, 11 Gilbertson Drive
Simcoe, ON, Canada N3Y 4K3
T. 1.800.265.5462
F. 519.426.9380
www.hendersonplay.ca

Salesperson | A.C.
Drawn By | RLK
Date Drawn | April 28, 2021
Revised By |
Revision Date |

Product Line | Playsted/IT
Standard Compliance | CAN/CSA-Z614
Best User Age | 18m to 12 yrs
Protective Surfacing Type | Wood Chips
Accessibility | None
Number of Children | 34
Fall Height | 9'

Border Area |
Border Perimeter |
Installation Type | In-ground

WARNING: All this equipment shall have a protective surfacing that complies with applicable local, provincial, national or international standards for such type of equipment and all depths to meet the current standards as specified by the CAN/CSA Z614, ASTM F1951 and the AS/NZS Consumer Product Safety Code.

19

Green Roots Play Equipment Inc
 793 Dalkeith Avenue
 North Saanich BC V8L 5G7
 info@greenrootsplayequipment.ca



Estimate

ADDRESS

Village of Salmo
 423 Davies Avenue
 PO Box 1000
 Salmo BC V0G 1Z0

SHIP TO

Village of Salmo
 423 Davies Avenue
 PO Box 1000
 Salmo BC V0G 1Z0
 Attn: Alana Lins

ESTIMATE # EST-2656
DATE 04/29/2021

ACTIVITY	QTY	RATE	AMOUNT
Playground Equipment Option 1 - B308096R0 PlaySteel FIT Structure	1	15,029.00	15,029.00
Playground Equipment Lucky Clover	1	1,415.00	1,415.00
Playground Equipment Skateboard Rider	1	956.00	956.00
Playground Equipment Swirly Spinner	1	1,761.00	1,761.00
Site Furnishings 6' Rectangular Picnic - Portable Table	1	1,128.00	1,128.00
Shipping/Freight Shipping to Nelson	1	2,400.00	2,400.00
Installation. Assembly and Installation of the above playground equipment	1	6,087.00	6,087.00

Palmetto Saucer is not included in above pricing, however it is included in the layout to show approximate area required for purchaser's dish swing.

SUBTOTAL 28,776.00
GST @ 5% 1,438.80
TOTAL **\$30,214.80**

Site preparation is the responsibility of the purchaser and must be completed to the specifications outlined by Green Roots Play Equipment Inc. Designs are based on the dimensions of the drawings provided by the purchasers. Digging for footings and access by machinery and equipment must be reasonable or additional charges may be incurred. Purchasers are responsible for obtaining and providing utility clearances and locates and agrees to indemnify and save harmless Green Roots Play Equipment Inc from any and all

Swingtime
playgrounds & parks 

 **Blue Imp**TM
PLAY STRONG

Quote #2

Proudly Made in Canada 

Image of Salmo
423 Davies Avenue
Salmo, B.C. V0G 1Z0





1485 Norton Court
 North Vancouver B.C. V7G 2E5
 Ph: 604 990 9187 / 1 800 816 6949
 info@swingtimedistributors.com

Quotation

Date	Estimate #
2021-04-21	9161

Name / Address
Alana Lins Village of Salmo 423 Davies Avenue Salmo, B.C. V0G 1Z0

Ship To
Village of Salmo 423 Davies Avenue Salmo, B.C. V0G 1Z0 Contact: Alana Lins Number: 1-250-357-9433

Project	Terms	Rep	FOB
	Net 30	RT	Med Hat

Qty	Item	Description	Price	Total
1	I09731	Blue Imp, Prairie Gold Play Structure	19,598.00	19,598.00
1	CN-1008	Quark Climber	5,500.00	5,500.00
1	CN-30-511B	School Bus c/w Coil Spring U-Swing By Others	1,403.00	1,403.00
1	Shipping	Shipping	1,500.00	1,500.00
		Note Supervised Installation \$3950.00 plus GST		
		GST	5.00%	1,400.05
		PST	7.00%	1,960.07
			Tax	\$3,360.12
			Total	\$31,361.12

Signature

_____ 

DRAWINGS AND SPECIFICATIONS ARE PROPERTY OF S.F. SCOTT MANUFACTURING. THIS DRAWING MAY NOT BE REPRODUCED IN WHOLE OR IN PART WITHOUT THE PRIOR WRITTEN CONSENT OF THE ENGINEERING DEPARTMENT

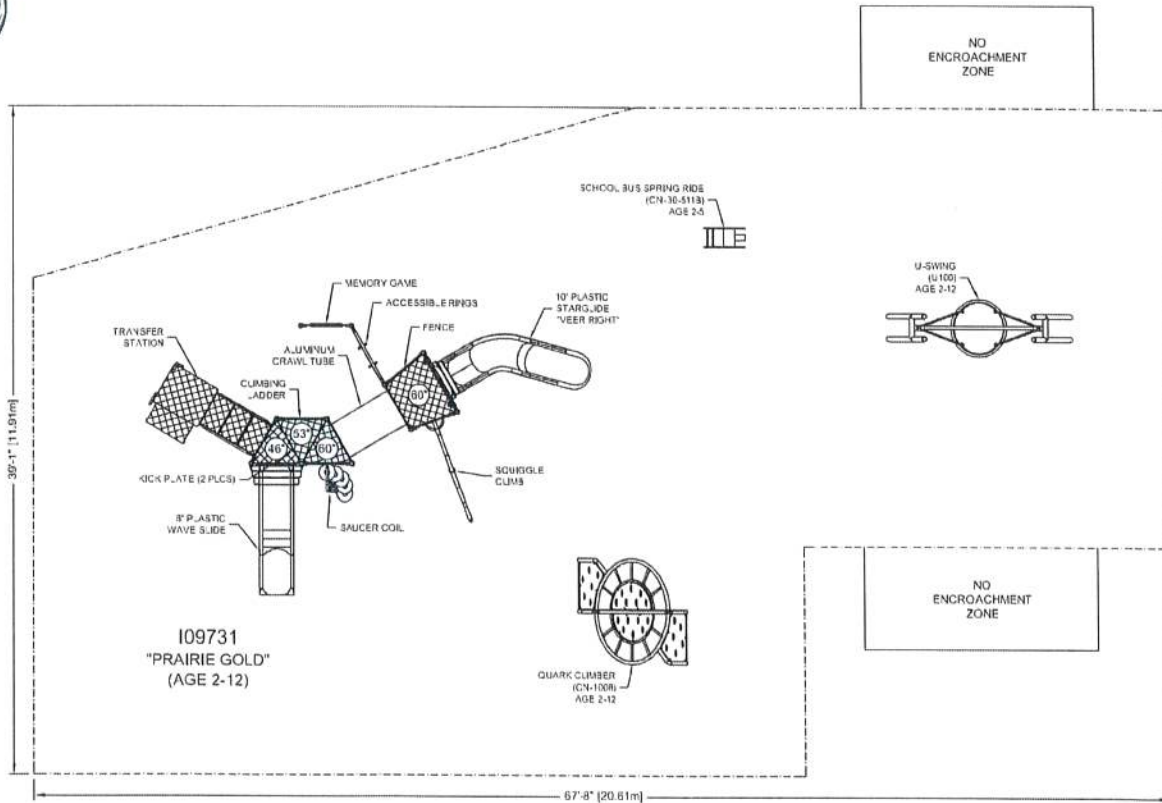

- CONFORMS TO THE CAN CSA-Z614-20 STANDARD 'CHILDREN'S PLAYGROUND EQUIPMENT AND SURFACING'
- PERIMETER SHOWN REPRESENTS EXTENT OF REQUIRED SAFETY SURFACING. WIDTH OF BORDER MATERIAL MUST BE ADDED BEFORE EXCAVATION.

BLUE IMP RECOMMENDS THAT SLIDES BE INSTALLED WITH SLIDE BEDS FACING BETWEEN NORTH AND EAST

LIONS PARK
VILLAGE OF SALMO

SALMO, BC
SWING TIME DISTRIBUTORS









LAYOUT #: A08301
JOB #: J06898

RECOMMENDED AGES: AS NOTED
PROTECTIVE SURFACING REQUIRED:
AREA: 2171 (sq.ft) PERIMETER: 205 (ft)
DRAWN BY: TD DATE: 22-APR-21

724 - 14TH STREET SW MEDICINE HAT, AB, T1A 4V7
TOLL FREE: 1-800-551-1162 FAX: (403) 529-0851
E-MAIL: sales@blueimp.com WEBSITE: www.blueimp.com

23

Elements of Play

-  Balancing
-  Spinning
-  Climbing
-  Swinging
-  Sliding
-  Brachiating
-  Accessible
-  Inclusive

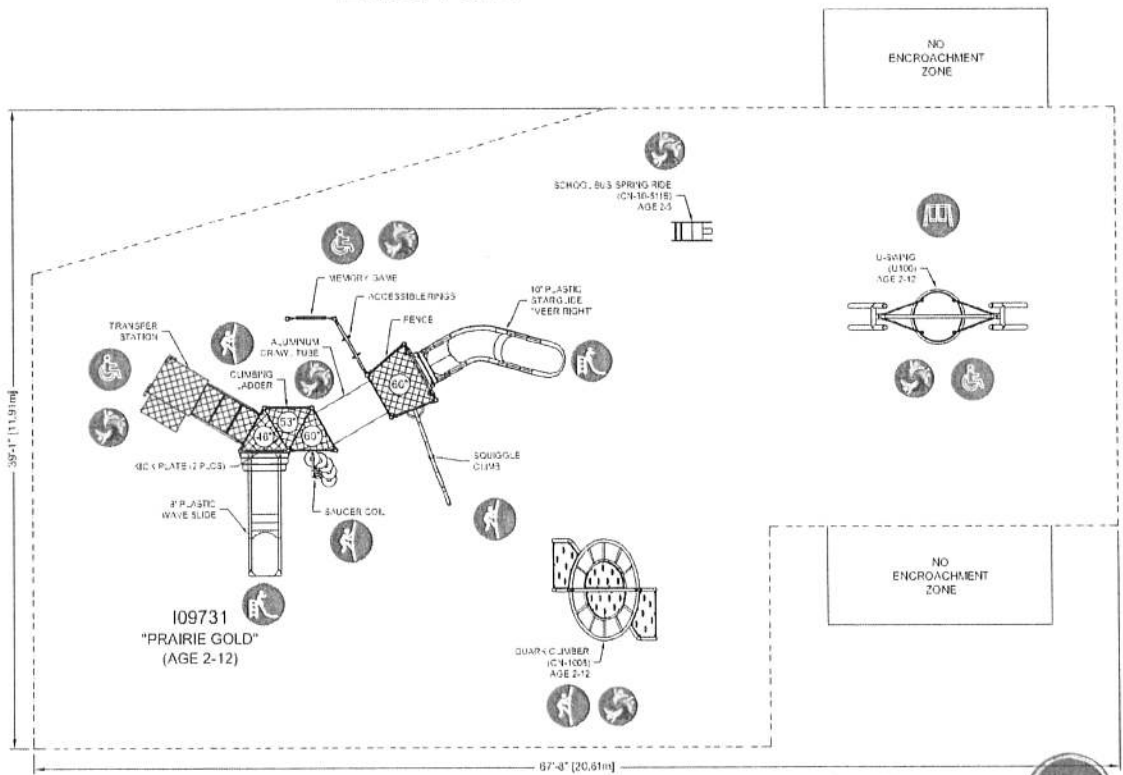

Please note for each option we have included our Elements of Play, which illustrates how each component addresses the 6 Elements: balancing, spinning, climbing, swinging, sliding, brachiating. The goal of inclusive play is to create a multi-faceted, sensory-rich play space where communities and generations can connect and where children – regardless of ability or disability, age, or stage, needs or preferences – can enjoy outdoor play. Inclusive play does not mean that every element of play is accessible to every child. It means incorporating a diversity of elements – ground level and elevated, physically challenging as well as sensory, imaginative, cognitive, and social – so that that the combination of experience is rewarding for each child.

24

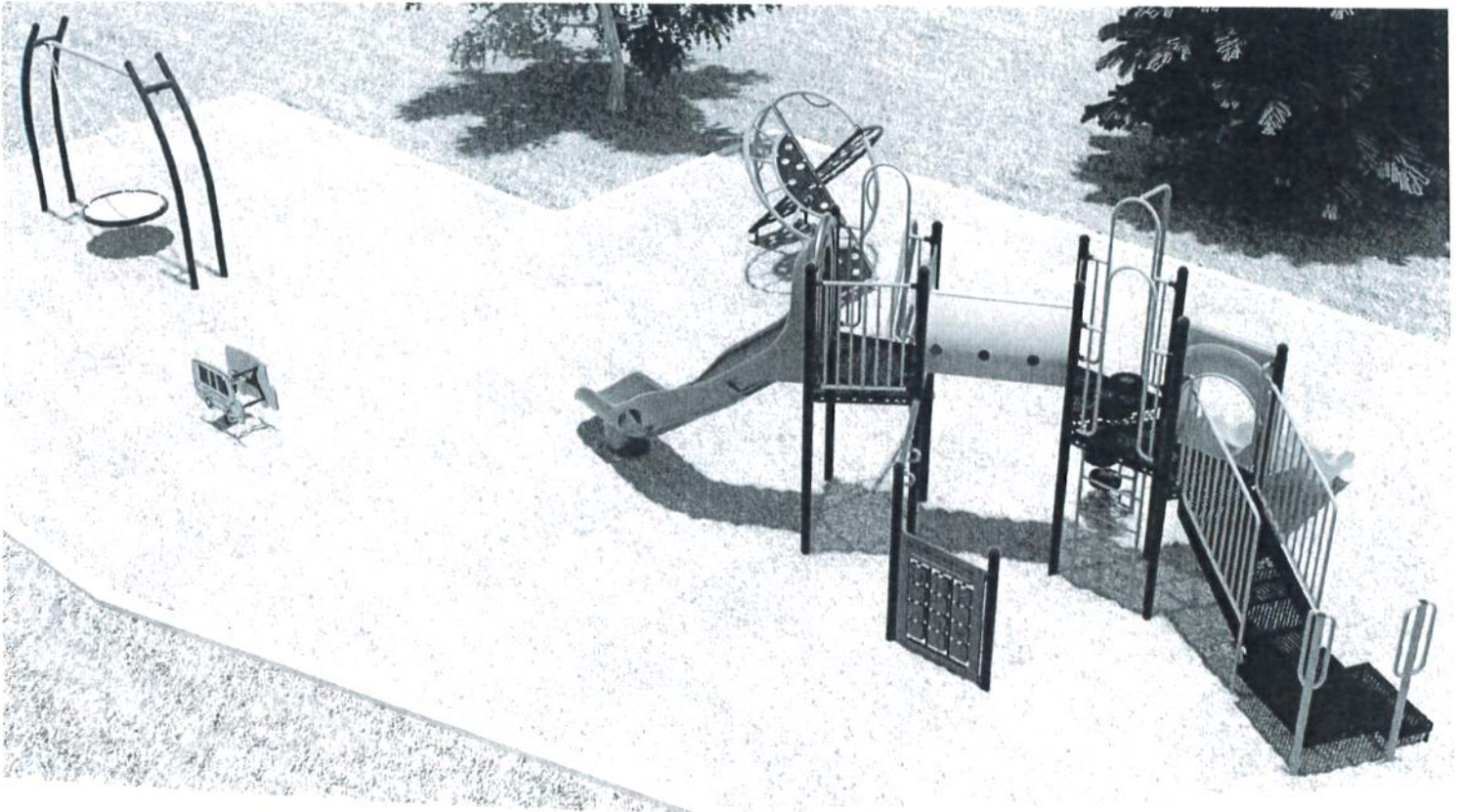

Note: Colours shown may not accurately reflect actual colours

Lions Park - Village of Salmo
layout # A08301-C1 | J08898



25

Other Swing Time/Blue Imp Configuration Options

FYI



layout # 105065-C1



BLUEIMP
Play Strong.

Note: Colours shown may not accurately reflect actual colours.

Cost \$24,030.00

23

layout #105374-C1

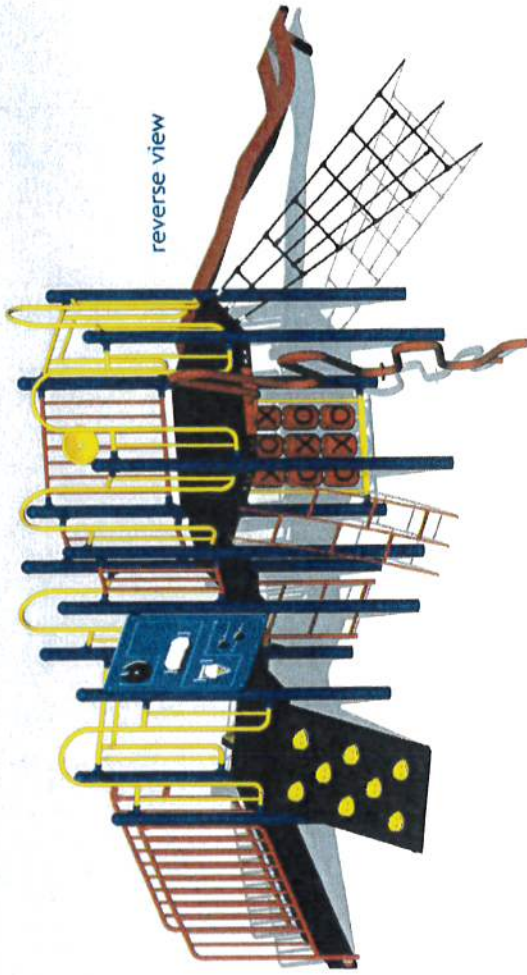

reverse view

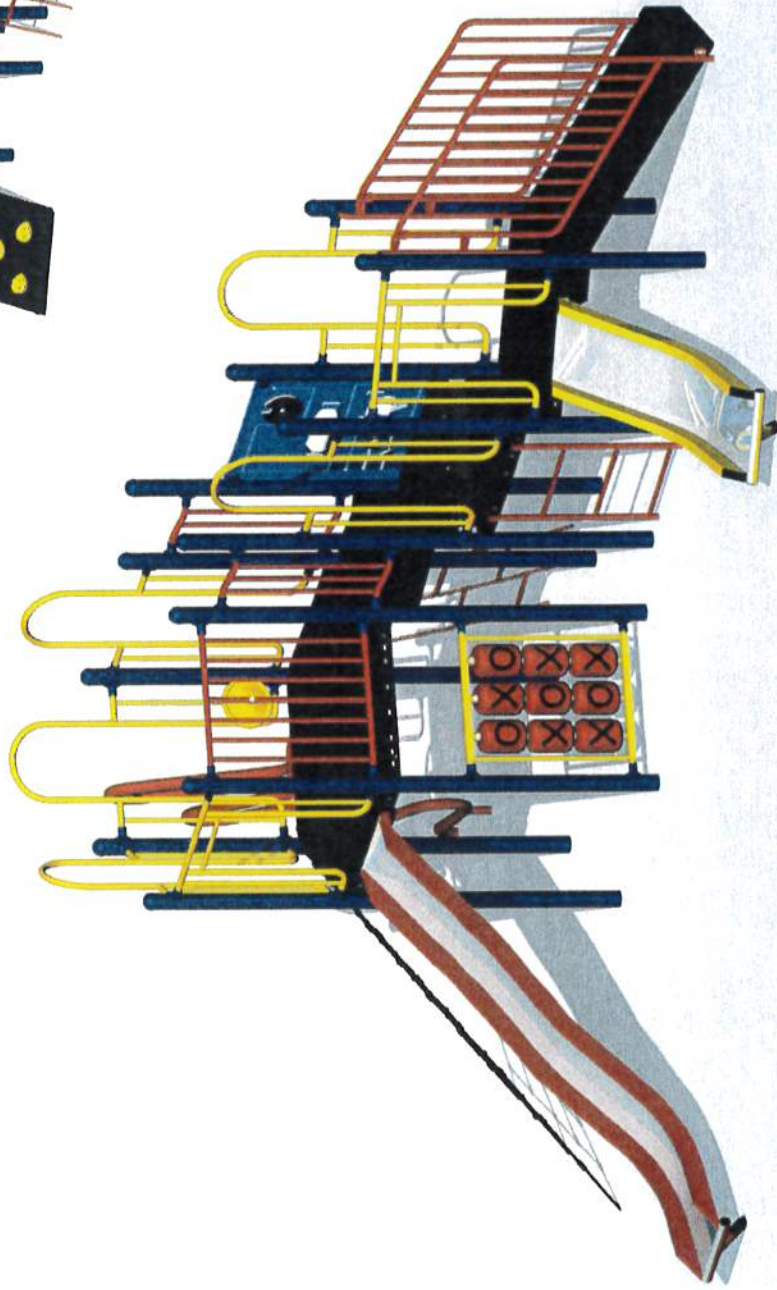

Note: Colours shown may not accurately reflect actual colours.



BLUE IMP
Play Strong.

Cost - \$24,090.00

28



reverse view

Note: Colours shown may not accurately reflect actual colours.



BLUEIMP
Play Strong.

layout # 103485-C1

Cost \$21,980

65



layout # 108438-C1



Note: Colours shown may not accurately reflect actual colours.

BLUE IMP
Play Strong.

Cost \$22,400.00

22

layout # 104702-C1

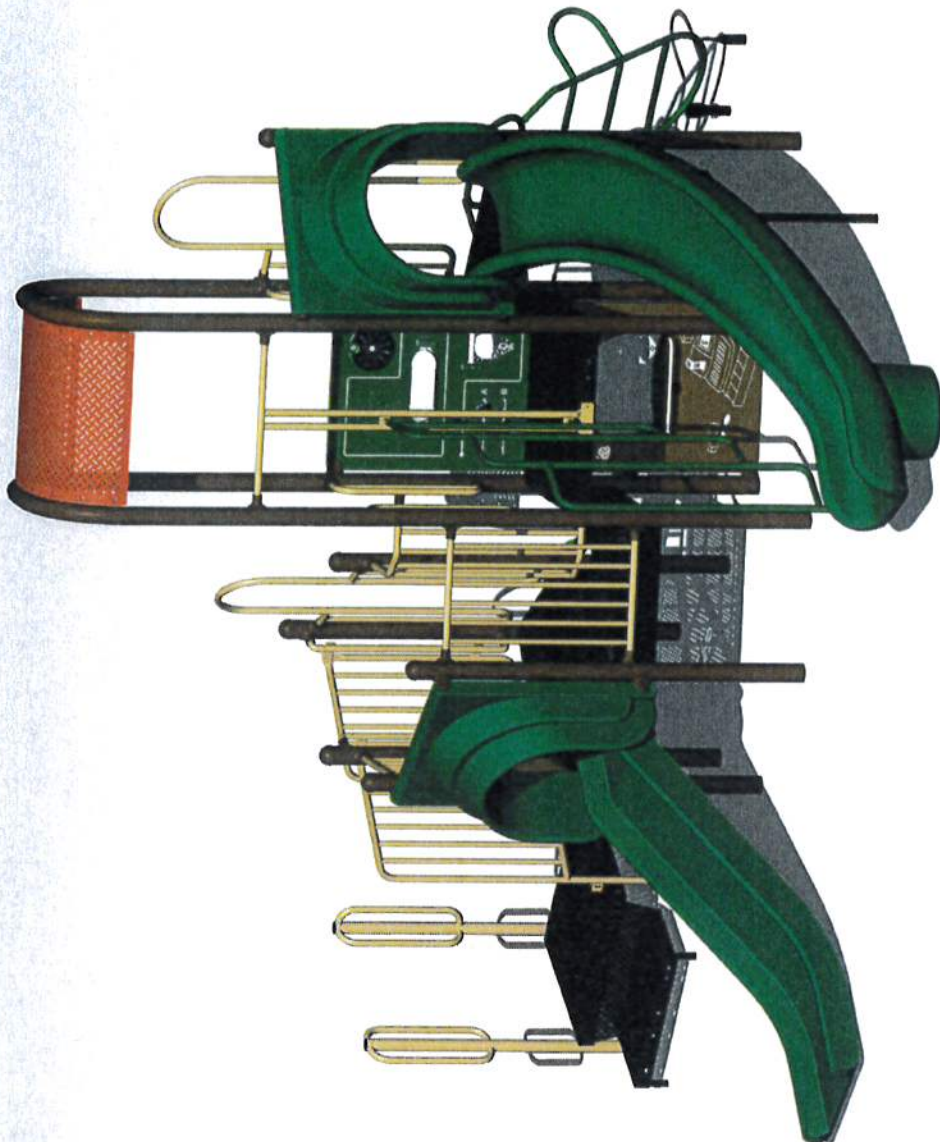

reverse view

Note: Colours shown may not accurately reflect actual colours.



BLUEIMP
Play Strong.

cost \$21,500.00

31

